

SECC Series

Spring Engaged Tooth Clutch Couplings

Eight standard frame sizes available:

- 4.5 to 10.6" diameter ; 3.8 to 8.6" length
- Bore sizes from 0.8 to 2.9"
- Static torque from 80 to 2600 lb-ft
- 1400 to 2500 RPM max speed
- Operates both dry and in oil
- Modified designs and customized assemblies available

Performance/Mechanical Specifications

		SECC Series — Model Size							
		450	525	525A	630	630A	760	895	1065
Torque Rating (Static)*	lb-ft	80	160	160	320	320	650	1300	2600
	Nm	108.5	216.9	216.9	433.9	433.9	881.3	1762.6	3525.1
Recommended Max Speed	RPM	2500	2000	2000	1600	1600	1500	1400	1400
Coil Data – 24VDC 110VDC	Amps	2.00	2.40	2.40	3.90	3.90	4.40	7.50	11.50
		0.40	0.43	0.43	0.70	0.70	1.00	1.20	2.20
Approximate Weight	lb	11	16	16	31	31	50	65	110
	kg	5.0	7.3	7.3	14.1	14.1	22.7	29.5	49.9

*Refer to Design Considerations – General Notes & Data for dynamic rating.

SECC Operation:

When current is applied to the coil in the magnet body, a magnetic field is created which attracts the armature toward the rotor, disengaging the teeth.

When the current is off, springs push the armature into engagement with the hub/output plate and torque is transmitted. The bearing-mounted hub coupling assembly simplifies installation.

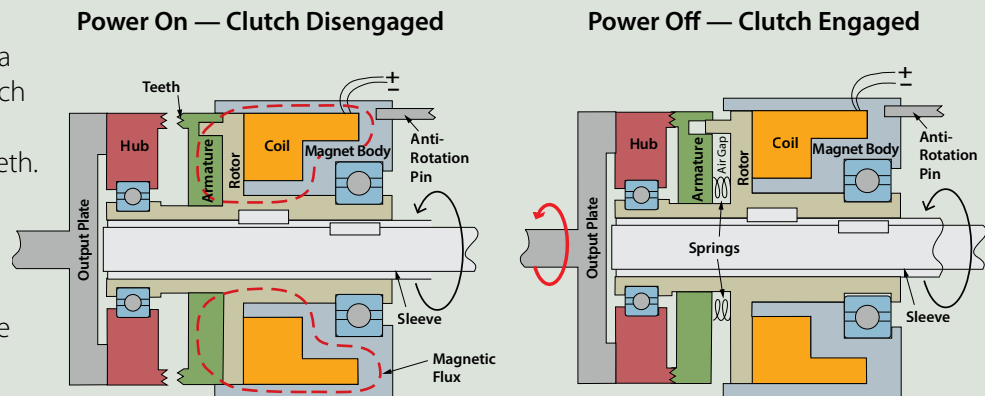

Tooth Clutches & Brakes

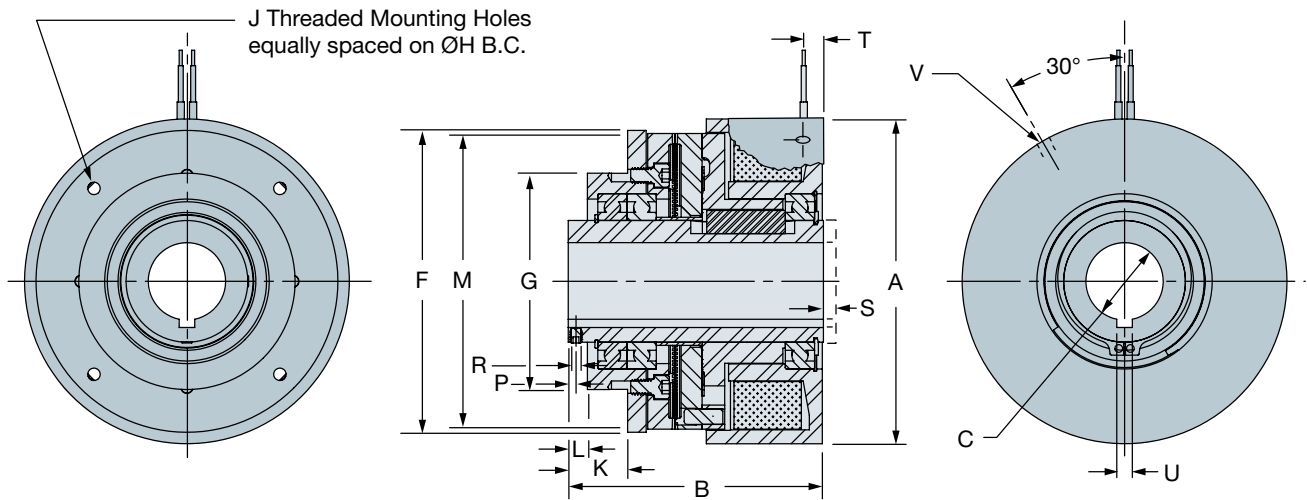

SECC Series — Model Size

Dimensions — Inches (mm)		450	525	525A	630	630A	760	895	1065	
Magnet Body Diameter	A	4.50 (114.3)	5.25 (133.4)	5.25 (133.4)	6.32 (160.5)	6.32 (160.5)	7.60 (193.0)	8.94 (227.1)	10.65 (270.5)	
Overall Length (ref)	B	3.88 (98.6)	4.12 (104.6)	4.12 (104.6)	4.62 (117.3)	4.62 (117.3)	5.38 (136.7)	6.61 (167.9)	8.62 (218.9)	
Sleeve Bore	C	0.875 (22.225)	1.125 (28.575)	1.125 (28.575)	1.500 (38.100)	1.750 (44.450)	1.937 (34.798)	2.000 (50.800)	2.937 (74.600)	
Alternative Sleeve Position	S	0.20 (5.1)	0.25 (6.4)	0.25 (6.4)	0.31 (7.9)	0.31 (7.9)	0.31 (7.9)	0.31 (7.9)	0.81 (20.6)	
Armature	Diameter	F	4.11 (104.39)	4.78 (121.41)	4.78 (121.41)	5.75 (146.05)	5.75 (146.05)	6.97 (177.04)	8.19 (208.03)	9.66 (245.36)
	Mounting Pilot	G	2.874	3.499	3.499	4.124	4.499	5.249	5.749	7.374
	Mounting Holes (Qty)	J	1/4-20 (4)	1/4-20 (4)	1/4-20 (4)	1/4-20 (4)	5/16-18 (4)	5/16-18 (4)	1/2-20 (4)	1/2-13 (6)
	Mounting Hole B.C.	H	3.437 (87.300)	4.062 (103.175)	4.250 (107.950)	4.750 (120.650)	5.250 (133.350)	6.125 (155.575)	7.000 (177.800)	8.500 (215.900)
Mounting Flange Adapter	Flange Diameter	M	3.88 (98.55)	4.50 (114.30)	4.88 (123.95)	5.38 (136.65)	6.00 (152.40)	7.00 (177.80)	8.19 (208.03)	9.50 (241.30)
	End to Pilot Flange	K	0.97 (24.6)	1.00 (25.4)	1.00 (25.4)	1.16 (29.5)	1.16 (29.5)	1.28 (32.5)	1.56 (39.6)	2.94 (74.7)
	End to Pilot Face	L	0.25 (6.4)	0.31 (7.9)	0.31 (7.9)	0.35 (8.9)	0.35 (8.9)	0.38 (9.7)	0.56 (14.2)	0.81 (20.6)
	Set Screw Location	P	0.12 (3.0)	0.12 (3.0)	0.12 (3.0)	0.22 (5.6)	0.22 (5.6)	0.25 (6.4)	0.25 (6.4)	0.50 (50.8)
	Set Screw Size x Depth (Qty 2)	R	#10-32x1/4	#10-32x13/8	#10-32x13/8	1/4-20x3/8	1/4-20x3/8	1/4-20x3/8	3/8-16x1/2	5/8-11x5/8
Lead Wire Location	T	0.31 (7.87)	0.34 (8.64)	0.34 (8.64)	0.39 (9.91)	0.39 (9.91)	0.39 (9.91)	0.51 (12.95)	0.57 (14.48)	
Keyway Size	U	3/16x3/32	1/4x1/8	1/4x1/8	3/8x3/16	3/7x3/16	1/2x3/16	1/2x1/4	3/4x1/4	
Anti-Rotation Hole	Depth - Max	V	0.34 (8.64)	0.47 (11.94)	0.47 (11.94)	0.53 (13.46)	0.53 (13.46)	0.65 (16.51)	0.75 (19.05)	0.86 (21.84)
	Thread Size		1/4-20	1/4-20	1/4-20	3/8-16	3/8-16	3/8-16	3/8-16	3/8-16